

# Technical Data Sheet

CODE 17006

## VORTICE LINEO 200 V0

In-line mixed flow fans



### Certifications



IMQ



CE



IMQ Performance



C Tick Mark



CCC



EAC

### TECHNICAL AND PERFORMANCE DATA

Absorbed power 1st speed (W)	98	Delivery 1st speed (l/s)	219,4
Absorbed Power max (W)	145	Delivery 1st speed (m <sup>3</sup> /h)	790
Frequency (Hz)	50	Max delivery at max speed (l/s)	294,4
Insulation Class	II°	Max delivery at max speed (m <sup>3</sup> /h)	1060
IP	44	Pressure - 1st speed (mmH2O)	29
Max ambient temperature for continuous operation (°C)	60	Pressure - 1st speed (Pa)	284,5
Max. absorbed Current at max. speed (A)	0,64	Pressure max - max speed (mmH2O)	33
Max. absorbed Current at min. speed (A)	0,43	Pressure max - max speed (Pa)	323,7
Max. absorbed power at max speed (W)	145	RPM max	2140
Voltage (V)	220-240	RPM min	1580
Weight (Kg)	3,7	Sound pressure level Lp [dB (A)] 3m - max speed	52,5
		Sound pressure level Lp [dB (A)] 3m - min speed	46,2

### DIMENSIONS

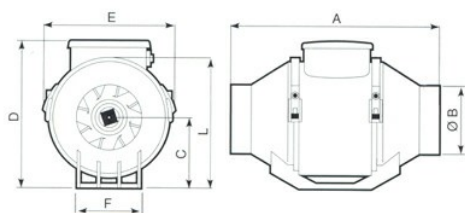

Size A (mm)	234,5
Size B (mm)	260,5
Size C (mm)	300
Size D (mm)	196
Size E (mm)	125,5
Size F (mm)	235
Size G (mm)	140
Size H (mm)	94
Size L (mm)	100
Size M (mm)	6

#### PER INFORMAZIONI:

Servizio al Cliente: tel +39 02 90699395 premendo 1 dopo messaggio registrato (consulenza su prodotti e impianti)

Pre & Post Vendita: fax +39 02 90699302

Email prevendita: [prevendita@vortice-italy.com](mailto:prevendita@vortice-italy.com)

# Technical Data Sheet

CODE 17006

## VORTICE LINEO 200 V0

In-line mixed flow fans



### DESCRIPTION

- Material: self-extinguishing plastic resin (self-extinguishing capability V0)
- Nominal diameter 200 mm.
- 2 speed AC motor with thermal overload cutout and shaft turning in ball bearings, coupled to mixed flow axial-centrifugal impeller.
- Minimum air flow 790 m<sup>3</sup>/h
- Maximum air flow: 1060 m<sup>3</sup>/h
- IMQ SAFETY and IMQ PERFORMANCE certifications
- Vortice speed controllers.

### CURVES

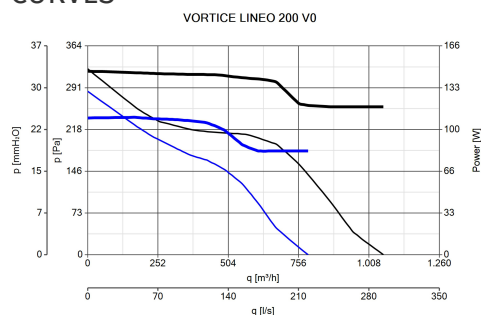

### ACCESSORIES

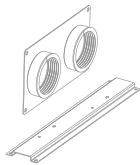

LINEO-PF 200  
Code 22582



LINEO-C 200  
Code 22588

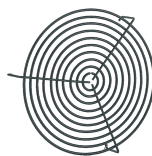

LINEO-G 200  
Code 22705

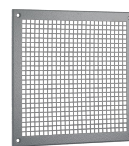

TRA 250  
(TELAIO CON  
RETE ANTINF.)  
Code 51150

#### PER INFORMAZIONI:

Servizio al Cliente: tel +39 02 90699395 premendo 1 dopo messaggio registrato (consulenza su prodotti e impianti)  
Pre & Post Vendita: fax +39 02 90699302  
Email prevendita: [prevendita@vortice-italy.com](mailto:prevendita@vortice-italy.com)